

Order Ref: 01-7030
(Chair not included)

Max: 120 kg/264 lbs

MobiStol is mounted on a chair to make it mobile. The chair can now be used for shorter transfers indoors, such as in and out from a table.

SystemRoMedic is a series of different models of transfer assistive devices. The choice of assistive devices depends on the transfer situation and the patient's functional capability and needs.



Functional inspection

Visual inspection

Check the condition and function of the product

regularly. Check to ensure that material is free from damage. If there are signs of wear, the product must be inspected and serviced.



Always read the manual

Always read the manuals for all assistive devices used during a transfer.

Keep the manual where it is accessible to users of the product.

Assembly instructions

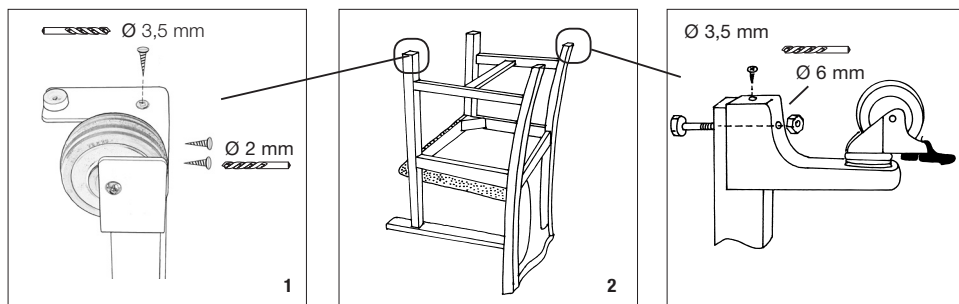

The wheels fit most chairs with square or rectangular legs made of a hardwood, e.g. beech, oak or birch, measuring 3x3 cm or larger.

Turn the chair upside down and hold the metal mounts with wheels against the chair legs, as shown in pictures 1 and 2.

Mark the position of the screw holes.

Drill about 2 cm deep for the woodscrews and straight through the rear legs for the bolts.

NOTE! The front wheels should be mounted on the outside of the legs, while the metal mounts for the rear wheels should be mounted on the inside and back.

NOTE! Drill the holes for the bolts from back to front.

NOTE! Check the screws and tightened them again after a few days.

Mounting of wheels on rear legs with different angles

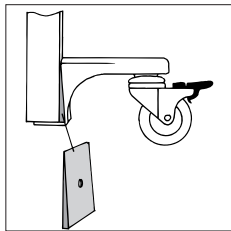

If the chair's rear legs are not inclined, plastic wedges are used.

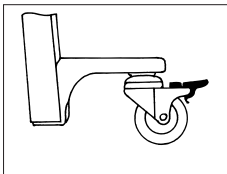

If the chair's rear legs are slightly inclined, no plastic wedges are used.

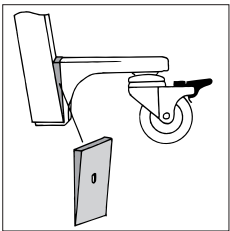

If the chair's rear legs are steeply inclined, plastic wedges are used.

Transfers



Always hold the chair and check to ensure that the wheels are locked before the patient sits in the chair or stands up from the chair. The wheels must be locked while the patient is left in the chair.

Locking rear wheels

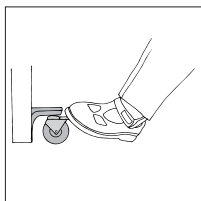

Lock the rear wheels by pressing down on the small metal plate with your foot. Disengage the wheel brake by lifting up on the plate with your foot.

Care of the product:

Clean the wheels regularly to keep them free of dust, dirt and hair.

CE Medical Device Class I

The product meets the requirements of the Medical Devices Directive 93/42/EEC.

SystemRoMedic™

Easy-to-use assistive devices for

Easy transfers and to making life and work easier for both patients and personnel in the care sector.

Experience, innovation and training are the basis for SystemRoMedic, a total solution for every imaginable transfer situation.

Transfer: products for moving patients between locations.

Positioning: products for repositioning in the same location.

Support: products that provide mobility support.

Lifting: products adapted for lifting.

The philosophy behind SystemRoMedic is to prevent occupational injuries while improving the patient's sense of independence and dignity. Through a combination of training and a complete range of transfer-assistive devices, SystemRoMedic offers the means to improving both the work environment and the quality of care while enabling significant cost savings.

Their mission, is to help people, has always been, and will continue to be, their driving force of innovation. They love easy transfers.



info@amilakesouthern.co.uk