

RiseUp600

SystemRoMedic™

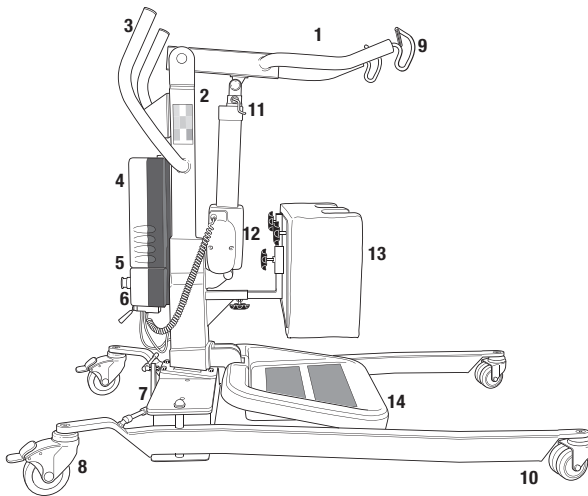

1. Boom
2. Mast
3. Handlebar
4. Battery pack
5. Emergency stop
6. Control box
7. Motor for base-width adjustment
8. Rear castors with brakes
9. Sling bar with safety latch
10. Front castors
11. Emergency lowering (mechanical)
12. Motor/actuator for boom
13. Padded leg support
14. Foot rest

SWL: 270 kg / 600lbs

RiseUp600 is a mobile sit-to-stand lift that has been developed for use in combination with the correct lifting accessories to help the patient to stand up comfortably from a seated position. It provides support under the feet, against the shins and behind the back. RiseUp600 has a two-point slingbar and is recommended only in combination with StandUpSling.

RoMedic's lifts and slings are part of the SystemRoMedic concept, which takes a holistic approach to patient transfers. SystemRoMedic has four categories: transfer, repositioning, support and lifting.



Functional inspection

Visual inspection

Inspect lift functions regularly. Check to ensure that material is free from damage.

Before use:

Ensure that the product is correctly assembled.

Check slingbar connection and safety latch function.

Check lift and base-width movement.

Check to ensure that the actuator is correctly installed.



Always read the manual

Always read the manuals for all assistive devices used during a transfer.

Keep the manual where it is accessible to users of the product.

The lift may only be used by persons who have received instruction in the operation of the lift.

Table of contents

Assembly	3-4
- Final inspection	4
Using the product	5-8
- Important information	5
- Safe working load	5
- Charging batteries	6
- Handset	6
- Emergency stop	7
- Emergency lowering	7
- Trouble shooting	7
- Trial operation	8
Maintenance	9
Technical information	10
- Dimensions RiseUp600EE	11

Assembling

Check to ensure that all components are included:

Mast with boom, lift motor, carry bar, control box and battery pack.

Base with motor and locking handle. Foot rest

Handset and cord.

Three screws for the base of the mast (one with a nut and washer, two with bolt and washer only).

Instructions, charging cable and power supply cord for charging.

Start by loosening one of the plastic covers on the mid-section (1).

1

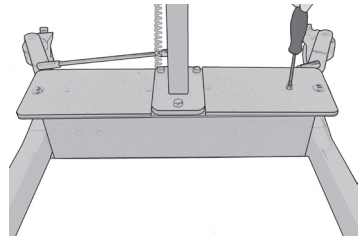

Place the mast in the base and secure the rear screws first.

Then, mount the foot rest and fasten the last screw with a nut underneath (2).

2

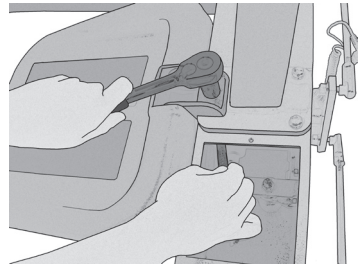

Finally, when all screws have been securely fastened, replace the plastic cover on the mid-section (1).

Connect the cables: Cable for handset in outlet 1; cable for lift motor in outlet 2, and cable for base motor in outlet 3 (3).

3

Place the battery in the mount in the control box. Connect the charging cable (4).

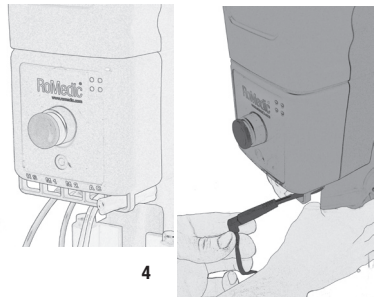

4

Release the emergency stop (5) and perform a final inspection (see final inspection).

5

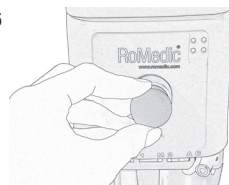

Final inspection

Check to ensure that no parts have been left in the packaging.
Inspect the lift for signs of wear and damage.
Check all four castor wheels and castor wheel locks.
Check all connections and fixtures including screws and bolts.

1

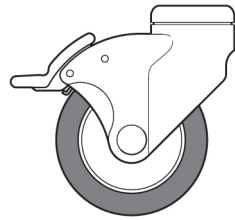

Check the emergency stop function by depressing the emergency stop, and then pressing either the up or down button. If nothing happens when the up or down buttons are pressed, the emergency stop is functioning properly.

2

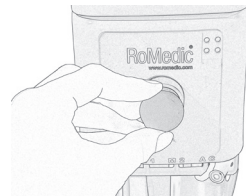

Grasp the handset, press the up button and run the lift arm all the way up. Then, press the down button and run the lift arm all the way down. Test base-width adjustment function. Press the button for base-width adjustment to widen the base fully, and then press the other button to narrow the base again.

3

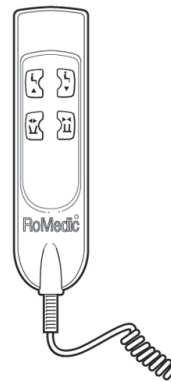

Test lift function by lifting a person (not a patient) using an approved sling. At the same time, check the emergency lowering function with someone on the lift. See section on Emergency lowering.

If the lift is functioning correctly, connect the charger and check to ensure that the charging lamp on the control box lights up.

NOTE!

Before the lift is used for the first time, it must be charged for at least 4 hours. See section on charging batteries.

Keep the manual where it is accessible to users of the product.

4

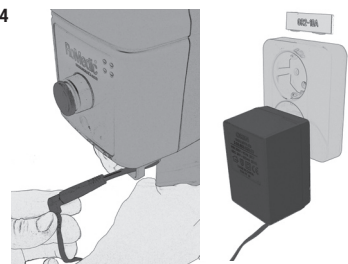

Using the product



Important Information

- The lift must be assembled according to the assembly instructions provided with the lift.
- The lift may only be used indoors and on a level floor.
- Lifting accessories must be properly fitted and tested in relation to the patient's needs and functional ability.
- Do not leave the patient unattended during a transfer situation.
- Under no circumstances may max. load be exceeded. See section on Safe working load.
- Never move the lift by pulling on the actuator! 
- The lift must not come in direct contact with water.
- The lift must not be charged in a wet room.
- To ensure optimal function, the lift must be inspected regularly. See section on Maintenance.
- Warranty applies only if repairs or alterations are done by an authorized technician.

Safe working load

Different products on the same lift system (lift unit, slingbar, sling, scales and other lifting accessories) may have different allowable safe working loads. The lowest allowable safe working load always determines the safe working load of the assembled system. Always check the safe working loads for the lift and accessories before use. Contact your dealer if you have any questions.

Charging batteries

Alternative charging procedures:

Freestanding adaptor

Connect the adaptor to the lift and to a wall outlet (1).

Check to ensure that the lamps on the control box light up. The green LED lamp indicates that the charger is receiving power and the yellow LED lamp indicates that the battery is charging (2).

Lock the castors when charging the battery.

Wall-mounted charger

Remove the battery pack from the lift and place it in the wall-mounted charger (3). Check to ensure that the LED lamp on the front of the charger lights up.

NOTE!

Before the lift is used for the first time, it must be charged for at least 4 hours.

For maximum battery life, charge batteries regularly. We recommend daily charging when the lift is used daily.

The emergency stop button must be pulled out during charging.

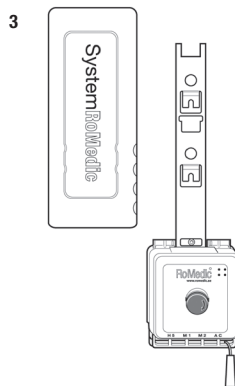
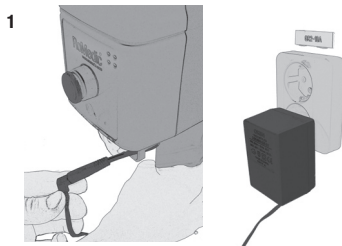

Handset

Raising/lowering the lift arm

Symbol indicate direction of travel.

Motion stops as soon as the button is released.

Widening/narrowing the base

Markings on the buttons indicate function.

Motion stops as soon as the buttons are released.

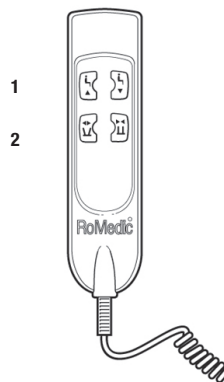

Emergency stop

To activate emergency stop:

Depress the red emergency stop button on the control box.

Resetting:

Turn the button in the direction of the arrows until the button pops out.

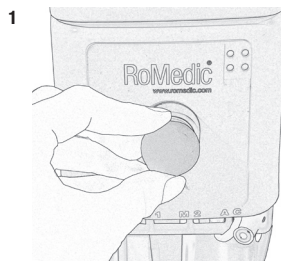

Emergency lowering

Manual emergency lowering:

For manual emergency, flip the clasp on the actuator upwards and turn the silver bar clockwise.

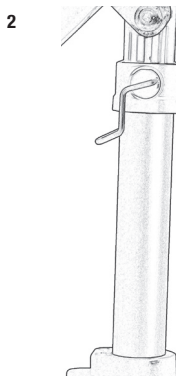

Trouble-shooting

If the lift or base-width adjustment cannot be activated, check the following:

- That the emergency stop button is not pressed in.
- That all cables are properly and securely connected. Pull out the contact and plug it in again firmly.
- That battery charging is not in progress.
- That the battery is charged.

If the lift is not working properly, contact your dealer.

If the lift makes unusual noises:

- Try to determine the source of the sound. Take the lift out of operation and contact your dealer.

Trial operation

Place the StandUpSling (recommended) behind the patient (1) (see manual StandUpSling) and move the foot rest of the wheelchair to one side before rolling the lift up in front of the patient.

The patient's feet are placed on the foot rest and the calf strap is fastened behind the calves for added security.

Make sure the patient's shins are resting against the leg support, and adjust the lower leg support, so that it is not pressing against the kneecaps (about 2 cm lower) (2).

Then, grasp the vest and select the shortest possible loop alternative (3).

Instruct the patient to lean back and make use of the back support during raising (4).

Perform a trial lift to ensure that sizes, adjustments and loop alternatives are correct (4-5).

Tips! Short patients require a longer loop alternative. This prevents them from being raised too high, which may cause discomfort. Tall patients require a shorter loop alternative to achieve a fully upright stance.

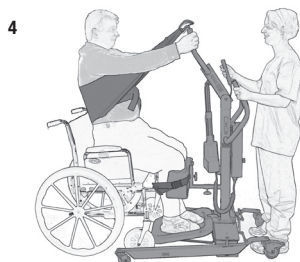
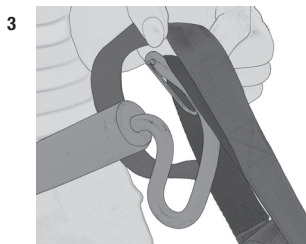
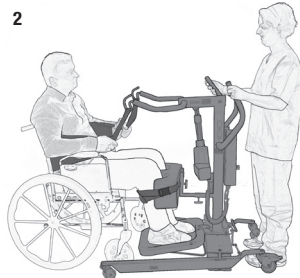

Maintenance

The lift must undergo thorough inspection at least once per year. Inspection must be performed by authorized personnel and in accordance with Handicare's service manual.

Repairs and maintenance may only be done by authorized personnel using original spare parts.



Spent batteries are to be left at the nearest recycling station. Spent batteries can also be returned to Handicare or a Handicare dealer for recycling.

Cleaning/disinfection

Clean the lift with warm water or rubbing alcohol and ensure that the castor wheels are free of dirt and hair. Do not use cleaning agents containing phenol or chlorine, as this may damage the material.

Storage

If the lift is not to be used for some time or e.g., during transport, we recommend that the emergency stop button be pressed in. Store the lift at a temperature above freezing point and not exceeding normal relative humidity (about 60%).

Service agreements

Handicare offers the possibility of service agreements for maintenance and regular testing of your mobile lift. Contact your local Handicare representative.

Technical information

Lifting speed:	3.5 cm/s without load
Batteries:	Two 12V, 4,5 Ah valve-regulated, sealed, lead accumulator (gel-type batteries)
Charger:	Max. 400mA
Motor (mast):	DC 24 V, 7 A. IP X4. Operationtime: 15% at maximum continous operation of 2 minutes, maximum 5 switching cycles per minute. Push: 10 000N.
Motor (base):	24 V, 7 A, IP X4. Operationtime: 15% at maximum continous operation of 2 minutes, maximum 5 cycles per minute. Push: 1000N.
Sound level:	With load: upwards: 74,7 dB(A) downwards: 52,6 dB(A).
Operating forces	
buttons on handset:	1,5N.
Material:	Steel
Emergency lowering:	Mechanical
Castors:	Back 4", 100mm, front 3", 75mm
IP class:	IP X4

The lift complies with the requirements of Council Directive 93/42/EEC of 14. June 1993 concerning medical devices.



The device is intended for indoor use.



Type B, according to the degree of protection against electric shock.

Dimensions RiseUp600EE

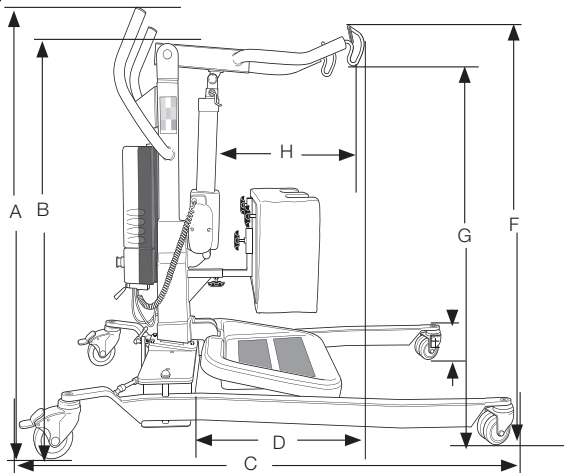

	A	B
A	104	41
B	101	40
C	137	54
D	50	19,7
E	11	4,3
F	98-155	38,5-61
G	97-152	38-60
H	39,5	15,5
I	80	31,5
J	39	15,3
K	39	15,3

I is minimum distance from wall to slingbar at maximum height (legs spread).

J is minimum distance from wall to slingbar at maximum reach (legs spread).

K is minimum distance from wall to slingbar at minimum height (legs spread).

Column A is measure in cm and weight in kg.

Column B is measure in inch and weight in lbs.

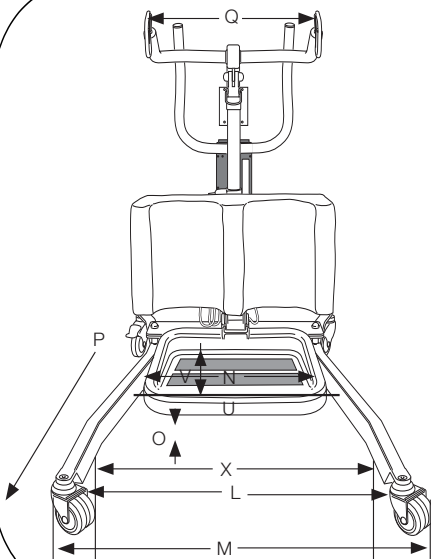

	A	B
L	72-109	28.5-43
M	85-114	33.5-45
N	55	21.5
O	10	4
Q	43	17
R	56	123,5
S	27,5	60,6
T	140	55,1
V	14	5,5
X	69	27

P is movement in forward direction

R is total weight of lift

S is the weight of the heaviest component

T is turning diameter

U is reference measure 70 cm with max legspreading

X is internal width at maximum reach

IMPORTANT SAFETY NOTES PLEASE READ

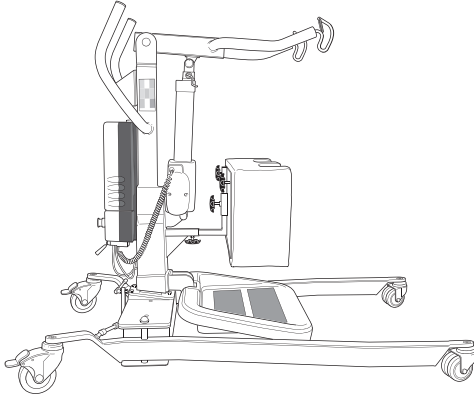

Regular inspection

Inspect the lift for signs of wear and damage.
Check all four castor wheels and castor wheel locks.

Check emergency stop function by depressing the emergency stop, and then pressing either the Up or Down button. If nothing happens when the Up or Down buttons are pressed, the emergency stop is functioning properly.

Grasp the handset, press the Up button and run the lift arm all the way up. Then, press the Down button and run the lift arm all the way down.

Test lift function by lifting a person (not a patient) using an approved sling. At the same time, check the emergency lowering function with someone on the lift. See section on Emergency Lowering in the manual.

If the lift is functioning correctly, connect the charger and check to ensure that the charging lamp on the control box lights up.

General

Read the section in the manual under the heading "Other maintenance details" on daily care and cleaning.
See Periodic Inspection for details on annual inspection of the lift.
Consult the Service Manual when servicing the lift.

Periodic inspection and service must be performed by an authorized technician.

SystemRoMedic™

For 25 years we have applied ourselves wholeheartedly to developing smart and easy-to-use assistive devices for easy transfers and to making life and work easier for both patients and personnel in the care sector.

Experience, innovation and training are the basis for SystemRoMedic, a total solution for every imaginable transfer situation.

Transfer: products for moving patients between locations.

Positioning: products for repositioning in the same location.

Support: products that provide mobility support.

Lifting: products adapted for lifting.

The philosophy behind SystemRoMedic is to prevent occupational injuries while improving the patient's sense of independence and dignity. Through a combination of training and a complete range of transfer-assistive devices, SystemRoMedic offers the means to improving both the work environment and the quality of care while enabling significant cost savings.

RoMedic's mission, is to help people, has always been, and will continue to be, the driving force of innovation. We love easy transfers.



P O Box 4791 Ferndown Dorset BH22 9WB

Tel: 07857 603031 Fax: 01202 877240

Email: info@amilakesouthern.co.uk