

Max: 200kg/440 lbs

MiniStretcher is used in emergency care units and ambulance services for lifting and transfer. Transfers between two locations, for example, bed to stretcher or lifting from the floor. MiniStretcher is easy to keep clean and store.

SystemRoMedic is a series of different models of transfer assistive devices. The choice of assistive devices depends on the transfer situation and the patient's functional capability and needs.

Functional inspection

Visual inspection

Check the condition and function of the assistive device regularly. Always inspect the product after laundering. Check to ensure that seams and material are free from damage. Check to ensure that fabric is not worn or faded. If there are signs of wear, the product must be discarded.

Always read the manual

Always read the manuals for all assistive devices used during a transfer.
Keep the manual where it is accessible to users of the product.
Do not leave the patient unattended during a transfer situation.



Mechanical load

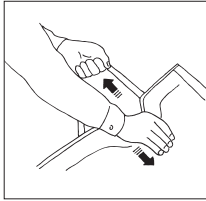
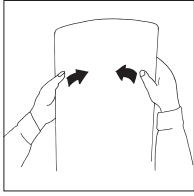

Carefully bend the MiniStretcher to check strength and durability. The mat should be both elastic and rigid. Discard the MiniStretcher when its strength and durability are diminished.

Pull on the handles to ensure that they withstand a heavy load. If there are signs of wear, the product must be discarded.

Placement and use of MiniStretcher

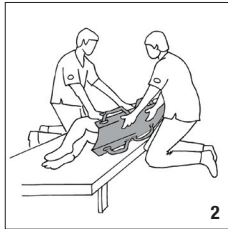
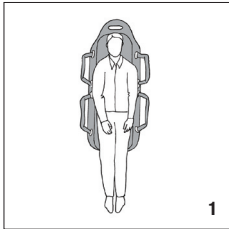

1. Place the patient centred on the MiniStretcher and ensure that there is sufficient support for the head.

2. Turn the patient on one side and fold the handles under the MiniStretcher before it is pushed in under the patient.

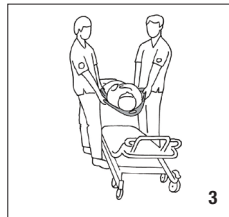

3, 4. Work in pairs (or more) one on either side, or one at each end, and lift the patient. Plan the transfer so as to minimize time taken, lifting and distance.

Storage and cleaning



Keep the MiniStretcher on an ambulance stretcher, as shown in the picture.

MiniStretcher should be cleaned with a pressure washer and disinfectant.

Material:

Polyester



P O Box 4791 Ferndown Dorset BH22 9WB

Tel: 07857 603031 Fax: 01202 877240

Email: info@amilakesouthern.co.uk