

EasyGlide

SystemRoMedic



01-5050 - 75 x 33 cm
30 x 13 inch



01-5020 - 60 x 33 cm
24 x 13 inch



01-5060 - 60 x 25 cm
24 x 10 inch



01-5070 - 45 x 20 cm
18 x 8 inch

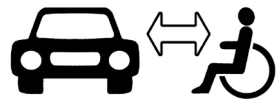
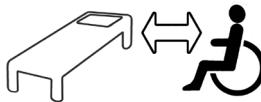

EasyGlide is used for transfers in the seated position between wheelchair and bed, toilet or car seat. EasyGlide is available in a range of sizes to meet most transfer needs. The smaller model is often used by active patients who can manage transfers on their own.

SystemRoMedic is a series of different models of transfer assistive devices. The choice of assistive devices depends on the transfer situation and the patient's functional capability and needs.



Functional inspection

Visual inspection

Check the condition and function of the assistive device regularly. Check to ensure that fabric is not worn or faded. If there are signs of wear, the product must be discarded.



Always read the manual

Always read the manuals for all assistive devices used during a transfer. Keep the manual where it is accessible to users of the product. Do not leave the patient unattended during a transfer situation.

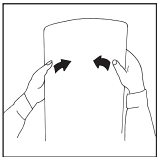

Functional inspection

Carefully bend the EasyGlide to check strength and durability. The mat should be both elastic and rigid. Discard the EasyGlide when its strength and durability are diminished.

Max. weight

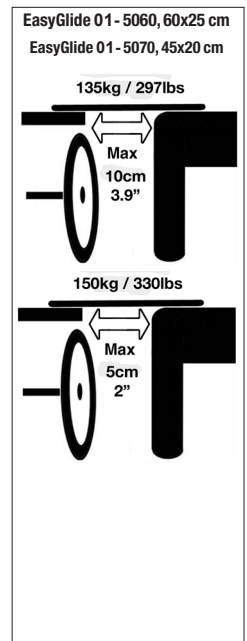
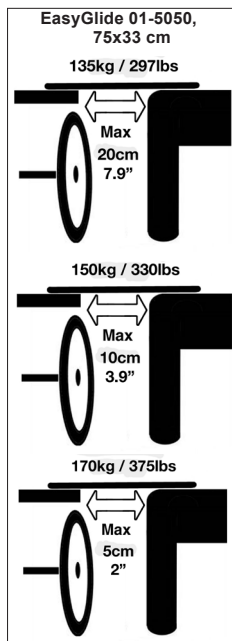
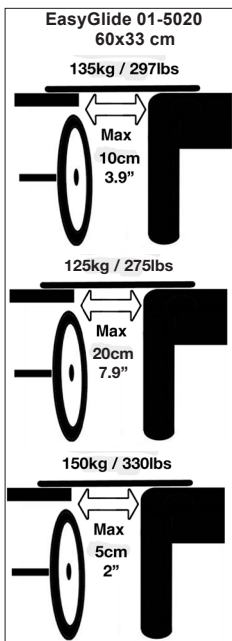

Placement/removal of EasyGlide

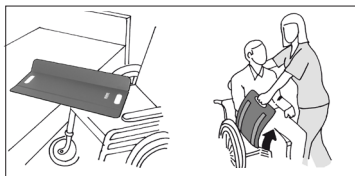

Place the wheelchair at an angle towards the side of the bed, and as close to the bed as possible. Remove the armrest that is closest to the bed and remove leg supports. Place the EasyGlide like a bridge between the bed and the wheelchair. If it is an EasyGlide model on which one long side can be bent, this should be placed against the wheelchair wheel.

To position the EasyGlide under the patient, lean the patient slightly in the opposite direction.

When the transfer is complete, EasyGlide is removed by bending upwards.

Using EasyGlide

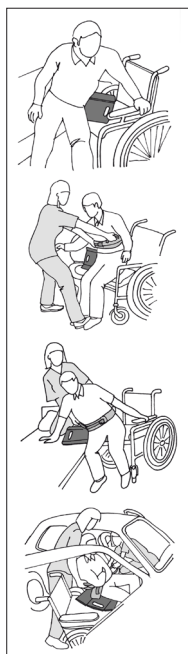

Active patients can transfer themselves with the help of EasyGlide. Grasp the armrest and lean over towards the wheelchair. It is important to remember to lean once more towards the bed when the transfer is complete, so as to be able to move back in the middle of the chair and slide all the way back.

If the patient requires support and assistance during the transfer, the EasyGlide should be complemented with an EasyBelt/FlexiBelt.

The caregiver can work from behind or in front of the patient.

Tips! FootStool can be used to advantage to raise the knees

EasyGlide can also be used for transfers into and out of a car.

Material:

Polyethen

Care of the product:

Clean EasyGlide with water and disinfectant.

CE Medical Device Class I

The product meets the requirements of the Medical Devices Directive 93/42/EEC.

SystemRoMedic™

Easy-to-use assistive devices for

Easy transfers and to making life and work easier for both patients and personnel in the care sector.

Experience, innovation and training are the basis for SystemRoMedic, a total solution for every imaginable transfer situation.

Transfer: products for moving patients between locations.

Positioning: products for repositioning in the same location.

Support: products that provide mobility support.

Lifting: products adapted for lifting.

The philosophy behind SystemRoMedic is to prevent occupational injuries while improving the patient's sense of independence and dignity. Through a combination of training and a complete range of transfer-assistive devices, SystemRoMedic offers the means to improving both the work environment and the quality of care while enabling significant cost savings.

Their mission, is to help people, has always been, and will continue to be, their driving force of innovation. They love easy transfers.



info@amilakesouthern.co.uk