

EasyGlide, 85 x 39 cm, is used for horizontal transfers between bed and x-ray table/operating table/ gurney/shower trolley. For the sake of safety, both underlying surfaces should be firm when transferring between bed and gurney. EasyGlide can also be used to assist placement of a sling in both the recumbent and seated positions.

SystemRoMedic is a series of different models of transfer assistive devices. The choice of assistive devices depends on the transfer situation and the patient's functional capability and needs.

Functional inspection

Visual inspection

Check the condition and function of the assistive device regularly. Check to ensure that fabric is not worn or faded. If there are signs of wear, the product must be discarded.

Functional inspection

Carefully bend the EasyGlide to check strength and durability. The mat should be both elastic and rigid. Discard the EasyGlide when its strength and durability are diminished.

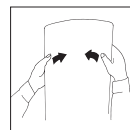

Always read the manual

Always read the manuals for all assistive devices used during a transfer.

Keep the manual where it is accessible to users of the product.

Do not leave the patient unattended during a transfer situation.

Safety



For the sake of safety, both underlying surfaces should be firm when transferring between bed and gurney. Max. weight of 135 kg applies for a distance of max. 5 cm.

Transfer from bed to bed

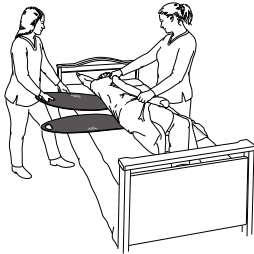

The EasyGlide is placed under the hips and shoulders.

The patient is turned on one side. A draw sheet can be used to facilitate the transfer. Guide the EasyGlide in under the patient, between the bed sheet and the draw sheet. Press the EasyGlide down into the mattress somewhat and push in.

Ensure that the weight of the hips and shoulders is centred on the EasyGlide.

NOTE! If two or more transfer slides are used, take care to ensure that the skin is not pinched between the transfer slides.

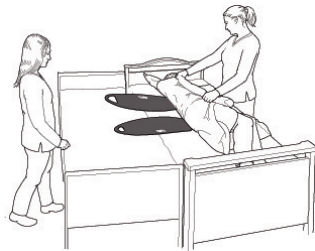

Transfer on transfer slides. Place the transfer slide between the two underlying surfaces. By using a draw sheet, the caregiver's reach is extended, allowing a better working stance.

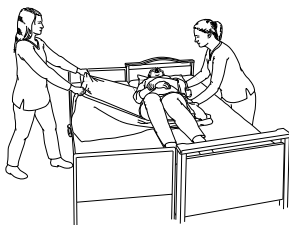

Make sure the transfer slides are between the two underlying surfaces and that the gap between the beds does not exceed 5 cm. Lean the patient towards the transfer slides and pull the draw sheet to transfer the patient.

Removal

The transfer slides are removed by grasping the handles and drawing outward. Prevent the patient's body from moving by holding the patient as the slides are pulled out.

Repositioning higher up in bed

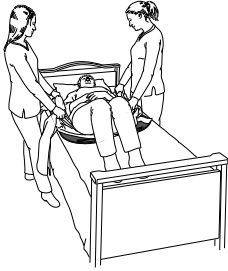

Place the sliding boards lengthwise under both sides of the patient. They should cover the shoulders and the entire back, down to the tail bone.

The sliding boards should be placed far enough in under the patient so that they meet in the middle, under the patient.

Standing in a walking stance, one on either side of the bed, the caregivers grasp the handles, and then step in the direction of transfer.

Application of the sling in a recumbent position

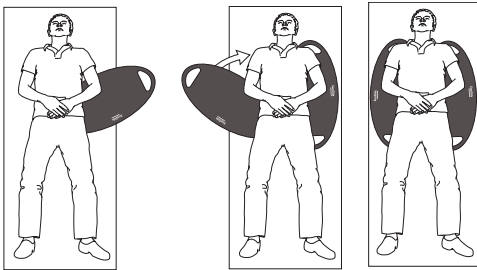

Place the sliding boards lengthwise under both sides of the patient. They should cover the shoulders and the entire back, down to the tail bone.

The sliding boards should be placed far enough in under the patient so that they meet in the middle, under the patient.

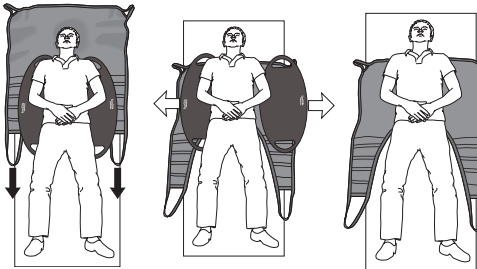

Place the sling with the leg sections facing downward and the back section against the bed or underlying surface. Pull the sling between the sliding boards and the underlying surface until it reaches the patient's tail bone. Ideally, placement of the sling should be performed by two caregivers, one on either side of the patient, pulling the sling downward and taking care to ensure that it is centred under the patient.

Remove the sliding boards and apply the leg sections (see the user manual for the sling model that is being used).

Application of the sling in a seated position



Place two EasyGlides behind the patient, between the patient's back and the wheelchair backrest. Then, place the sling between the two sliding boards, taking care to ensure that the middle of the sling is aligned with the patient's spine. Grasp the sling and pull it into place behind the patient. When the sling has been pulled down far enough, remove the sliding boards and apply the leg sections (see the user manual for the sling model that is being used).

Care of the product:

Clean EasyGlide with water and disinfectant.

Material:

Polyethen

Sizes:

01-5040 85 x 39cm Single Board

01-5042 85 x 39cm 2 Boards



P O Box 4791 Ferndown Dorset Bh22 9WB

Tel: 07857 603031 Fax: 01202 877240 E mail: info@amilakesouthern.co.uk